

NOTE:
FIXTURES VARY ON EACH
PLUMBING PEDESTAL - REFER TO
PLAN FOR LOCATIONS

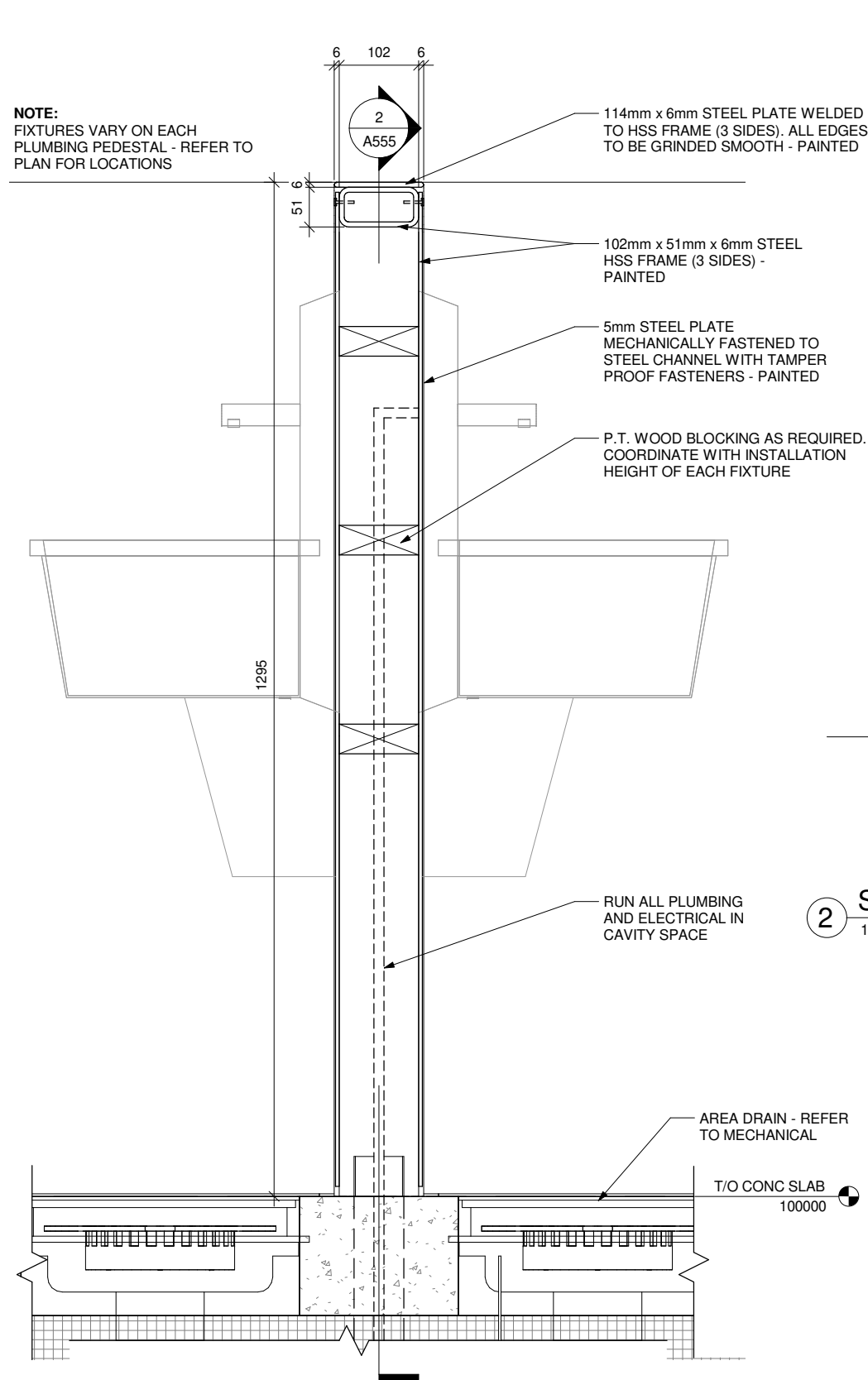

1 SECTION DETAIL - TYPICAL PLUMBING PEDESTAL - A
1:8

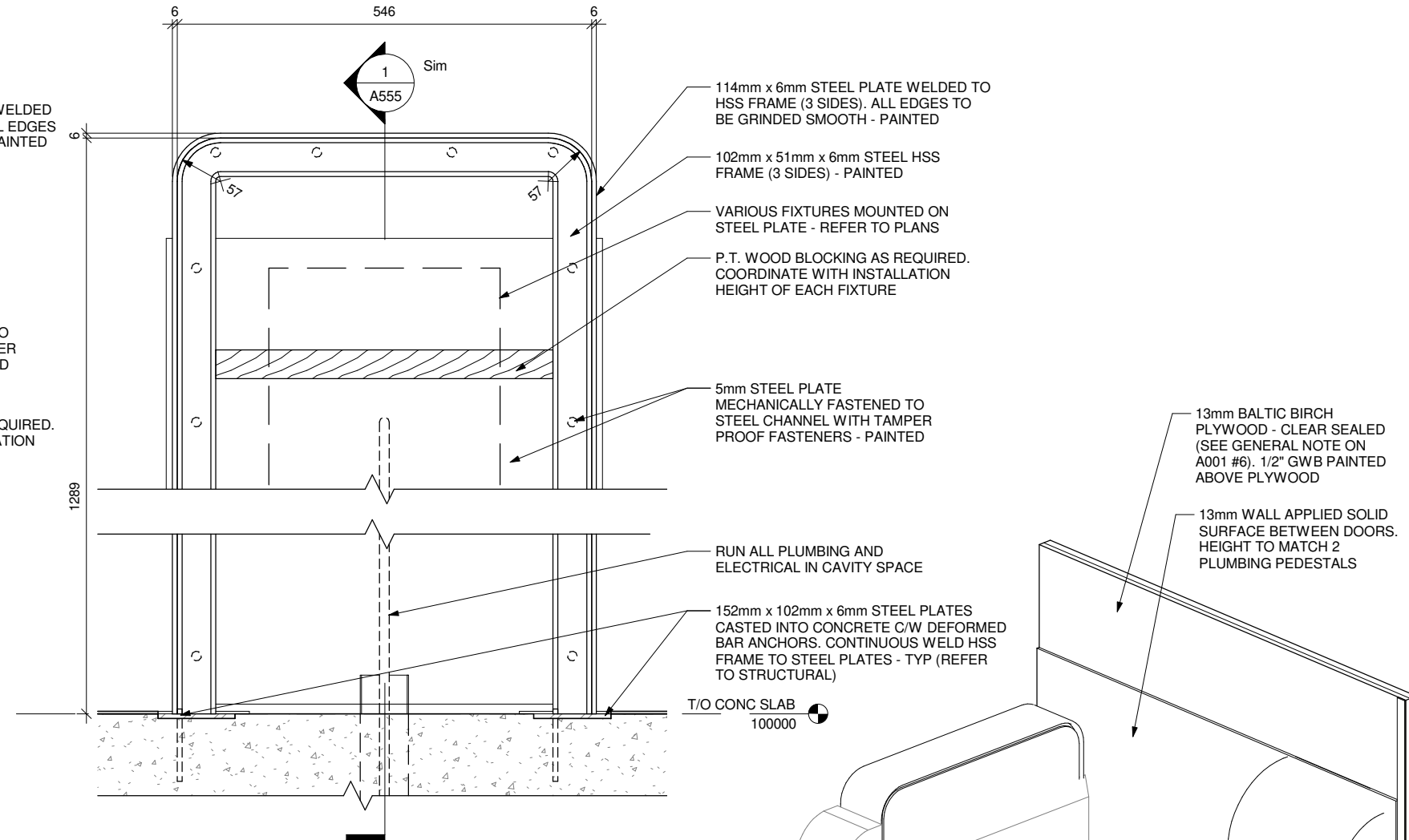

2 SECTION DETAIL - TYPICAL PLUMBING PEDESTAL 2
1:8

114mm x 6mm STEEL PLATE WELDED TO
HSS FRAME (3 SIDES). ALL EDGES TO
BE GRINDED SMOOTH - PAINTED

VARIOUS FIXTURES MOUNTED ON
STEEL PLATE - REFER TO PLANS

5mm STEEL PLATE MECHANICALLY
FASTENED TO STEEL CHANNEL WITH
TAMPER PROOF FASTENERS - PAINTED

152mm x 102mm x 6mm STEEL PLATES CASTED
INTO CONCRETE C/W DEFORMED BAR
ANCHORS. CONTINUOUS WELD HSS FRAME TO
STEEL PLATES - TYP (REFER TO STRUCTURAL)

TACTILE WARNING SURFACE AS PER SPEC

AREA DRAIN - REFER TO MECHANICAL

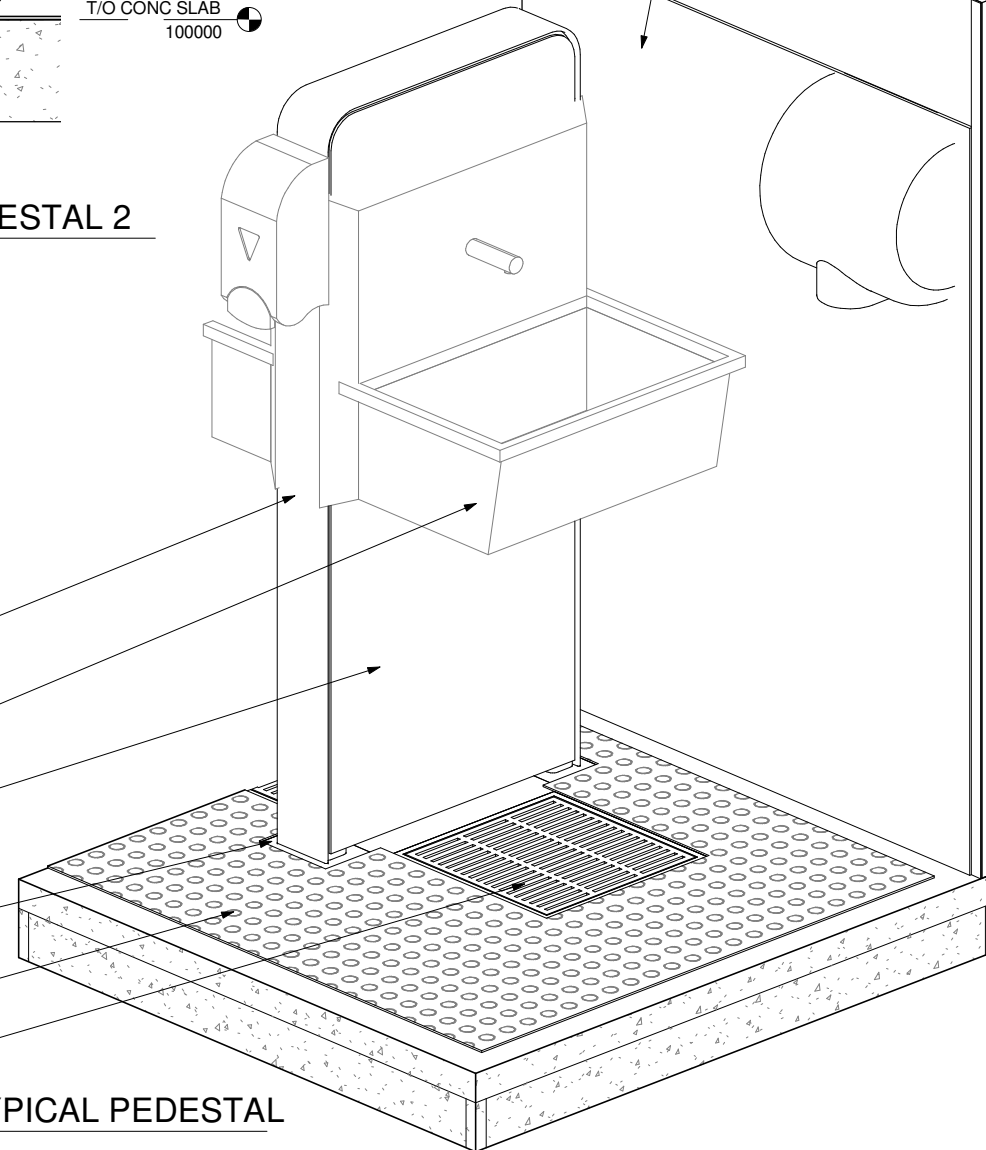

3 3D DETAIL - TYPICAL PEDESTAL

bridgmancollaborative
ARCHITECTURE

678 Main Street
Winnipeg, MB
R3B 1E4
204-488-3857

www.bridgmancollaborative.ca

Project:
715 MAIN STREET
PUBLIC TOILET

715 Main Street, Winnipeg, MB

Project Number: 2022
Bid Opportunity Number: 54-2021



#	Issue/Revision	Date
1	ISSUED FOR CONSTRUCTION	MAR. 3, 2021

Drawing Title:
PLUMBING PEDESTAL
DETAILS

Sheet No:
A555

This drawing is property of the Architect and cannot be reproduced or used without the consent of the Architect. The contractor is responsible for checking and verifying all levels and dimensions and shall report all discrepancies to the Architect and obtain clarification prior to commencing work.